

1 Churchill Avenue, Whalley Range, Manchester, M16 8JU



JP&Brimelow
ESTATE AGENTS

Offers In The Region Of £330,000

3 1 2 D

VIDEO TOUR AVAILABLE An attractive and spacious THREE BEDROOM, bay fronted, period, end terraced property is positioned in a leafy location off Clarendon Road in Whalley Range. The property is close to several schools, including the Ofsted "outstanding" Manley Park Primary School, the Hilary Step Bar and Manley Park and the local amenities of Chorlton. Ideally located for transport links to Media city, Manchester Airport and Manchester City Centre, either by Metrolink or by bus. The well-planned accommodation is set over two floors and consists; an entrance hallway, a through lounge/dining room with a bay window to the front aspect, a downstairs W.C and a good-sized fitted kitchen/breakfast room with views and access out to the rear enclosed courtyard. To the first floor there is landing leading to two double bedrooms, a further bedroom and a white three-piece family bathroom suite. The property benefits from being warmed by gas fired central heating, many period features throughout, front and rear enclosed paved courtyard garden. OFFERED WITH NO VENDOR CHAIN.





EPC Chart

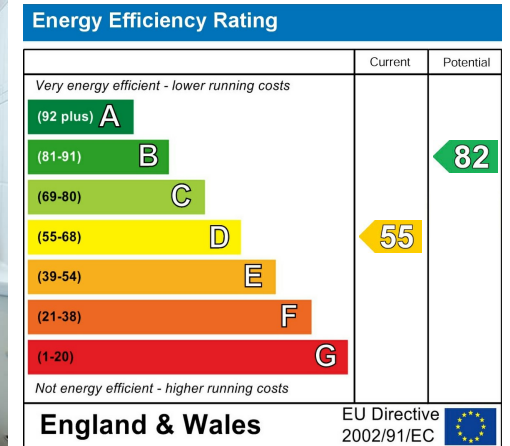

Tenure: **Leasehold** Council Tax Band: **A**

Ground Floor

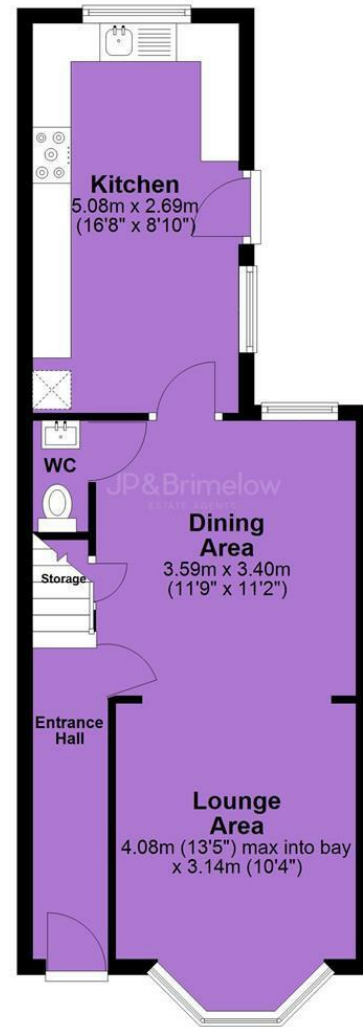

First Floor



JP & Brimelow Estate Agents Ltd
430 Barlow Moor Road, Manchester, M21 8AD
Tel: 0161 8822233
E: sales@jpbrimelow.co.uk www.jpandbrimelow.co.uk



JP & Brimelow
ESTATE AGENTS

NOTICE: JP & Brimelow Estate Agents Ltd for themselves and for the vendors or lessors of this property whose agents they are give notice that:

- (i) the particulars are set out as a general outline only for the guidance of intending purchasers or lessees, and do not constitute, nor constitute part of, an offer or contract;
- (ii) all descriptions, dimensions, references to the condition and necessary permissions for use and occupation, and other details are given in good faith and are believed to be correct but any intending purchasers or tenants should not rely on them as statements or representations of fact but must satisfy themselves by inspection or otherwise as to the correctness of each of them;
- (iii) no person in the employment of JP & Brimelow Estate Agents Ltd has any authority to make or give any representation or warranty whatever in relation to this property.

jpandbrimelowestateagents

@jpandbrimelow